

ISA-MYM-200 Single-Axis Robot: Medium Y-Axis Long Slider Type, Actuator Width 120mm, 200W, Straight Shape

ISPA-MYM-200 Single-Axis Robot: Medium Y-Axis Long Slider Type, Actuator Width 120mm, 200W, Straight Shape High-Precision Specification

Type Medium Y-axis (120-mm wide) long slider type Stroke 100 ~ 1000mm Load capacity 80kg (horizontal)/19kg (vertical)

Model specification items Series Type Encoder type Motor output Lead Stroke Applicable controller Cable length Options
 ISA[ISPA]-MYM-A-200-30-1000-T1-S-NM

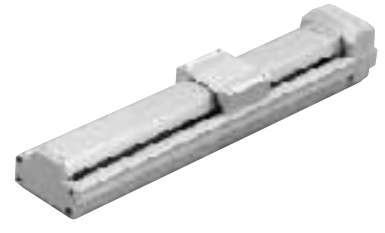

* Refer to page 11 for the details of model specification items.

Models/Specifications

Model	Encoder type	Motor output (W)	Lead (mm)	Stroke (mm) In increments of 50mm (Note 1)	Speed (Note 2) (mm/s)	Acceleration (Note 3)				Load capacity (Note 3)				Rated thrust (N)
						Horizontal (G)		Vertical (G)		Horizontal (kg)		Vertical (kg)		
						Rated	Maximum	Rated	Maximum	Rated	Maximum	Rated	Maximum	
ISA [ISPA]-MYM-A-200-30-***T1-△□	Absolute	200	30	100 ~ 1000	1 ~ 1500	0.3	1.0	0.3	1.0	25	10	6	2	113
ISA [ISPA]-MYM-A-200-20-***T1-△□			20		1 ~ 1000	0.3	1.0	0.3	0.8	40	12	9	5	169.5
ISA [ISPA]-MYM-A-200-10-***T1-△□			10		1 ~ 500	0.3	0.6	0.3	0.5	80	40	19	15	340.1
ISA [ISPA]-MYM-I-200-30-***T1-△□	Incremental	200	30	100 ~ 1000	1 ~ 1500	0.3	1.0	0.3	1.0	25	10	6	2	113
ISA [ISPA]-MYM-I-200-20-***T1-△□			20		1 ~ 1000	0.3	1.0	0.3	0.8	40	12	9	5	169.5
ISA [ISPA]-MYM-I-200-10-***T1-△□			10		1 ~ 500	0.3	0.6	0.3	0.5	80	40	19	15	340.1

* In the above model names, *** indicates the stroke, △ the cable length and □ the applicable options.

*1.0G=9800mm/sec²

Options

Name	Code	Page	Name	Code	Page
AQ seal	AQ	→ P13	Master-axis designation	LM	→ P14
Brake	B	→ P13	Master-axis designation (sensor on opposite side)	LLM	→ P14
Creep sensor	C	→ P13	Reverse homing specification	NM	→ P14
Creep sensor on opposite side	CL	→ P13	Guide with ball-retaining mechanism	RT	→ P14
Home limit switch	L	→ P14	Slave-axis designation	S	→ P14
Home limit switch on opposite side	LL	→ P14			

Common Specifications

* Refer to page 10 for the details of common specification items.

Positioning repeatability (Note 4)	±0.02mm [±0.01mm]
Drive system (Note 5)	Ball screw ø16mm, rolled C10 [equivalent to rolled C5]
Backlash (Note 6)	0.05mm or less [0.02mm or less]
Guide	Integrated with base
Allowable load moment	Ma: 69.6N • m Mb: 99.0N • m Mc: 81.3N • m
Overhung load length	Ma direction: 600mm or less, Mb/Mc directions: 600mm or less
Base	Material: Aluminum with white alumite treatment
Cable length (Note 7)	N: No cable, S: 3m, M: 5m, X □ □ : Length specification

Dimensions

* Note that changing the home direction will require the actuator to be returned to IAI for adjustment.

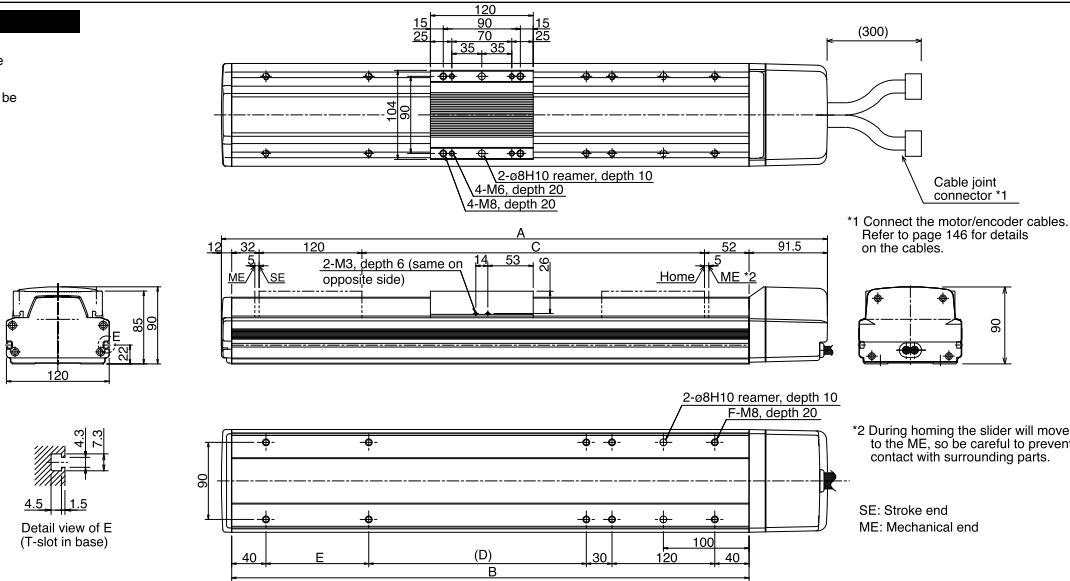

*1 Connect the motor/encoder cables. Refer to page 146 for details on the cables.

*2 During homing the slider will move to the ME, so be careful to prevent contact with surrounding parts.

Detail view of E (T-slot in base)

Dimensions, Weight and Maximum Speed by Stroke

Stroke	100	(150)	200	(250)	300	(350)	400	(450)	500	(550)	600	(650)	700	(750)	800	(850)	900	(950)	1000		
A	407.5	457.5	507.5	557.5	607.5	657.5	707.5	757.5	807.5	857.5	907.5	957.5	1007.5	1057.5	1107.5	1157.5	1207.5	1257.5	1307.5		
B	304	354	404	454	504	554	604	654	704	754	804	854	904	954	1004	1054	1104	1154	1204		
C	100	150	200	250	300	350	400	450	500	550	600	650	700	750	800	850	900	950	1000		
D	—	—	54	104	154	204	254	304	354	404	454	504	554	604	654	704	754	804	854		
E	120	—	120	120	120	120	120	120	120	120	120	120	120	120	120	120	120	120	120		
F	10	8	10	10	10	10	10	10	10	10	10	10	10	10	10	10	10	10	10		
Weight (kg)	6.8	7.3	7.8	8.3	8.8	9.3	9.8	10.4	10.9	11.4	11.9	12.4	12.9	13.4	13.9	14.4	14.9	15.4	15.9		
Maximum speed (mm/s)	Lead 30	1500																1500	1190	965	810
	Lead 20	1000																1000	795	645	540
	Lead 10	500																480	380	310	255

Applicable Controller Specifications

Applicable controller	Maximum number of controlled axes	Compatible encoder type	Program operation	Positioner operation	Pulse-train control	Supply voltage	Page
X-SEL	4 axes	Absolute/Incremental	○	△	×	AC100/200V	→ P241
E-Con	1 axis	Absolute/Incremental	×	○	×	AC100/200V	→ P227
P-Driver	1 axis	Incremental	×	×	○	AC100/200V	→ P234



(Note 1) The strokes that are set in increments of 50 mm are semi-standard settings.
 (Note 2) A longer stroke will result in a lower maximum speed to prevent the ball screw from reaching a dangerous speed. (Refer to the above table for the maximum speed at a given stroke.)
 (Note 3) Refer to page 40 for the relationship of acceleration and load capacity. (Notes 4, 5, 6) The figures in brackets apply to the ISPA Series.
 Other specification values apply to both the ISA and ISPA Series.
 (Note 7) The maximum cable length is 30 m. Specify the desired length in meters (e.g., X08 = 8 m).

* Refer to page 9 for other points to note.