

ISA-SYM Single-Axis Robot: Compact Y-Axis Type, Actuator Width 90mm, 60W, Straight Shape

ISPA-SYM Single-Axis Robot: Compact Y-Axis Type, Actuator Width 90mm, 60W, Straight Shape
High-Precision Specification

Type Compact Y-axis (90-mm wide) Stroke 100~600mm Load capacity 50kg (horizontal)/14kg (vertical)

Model specification items — Series — Type — Encoder type — Motor output — Lead — Stroke — Applicable controller — Cable length — Options
ISA[ISPA] - SYM - A - 60 - 16 - 600 - T1 - S - B

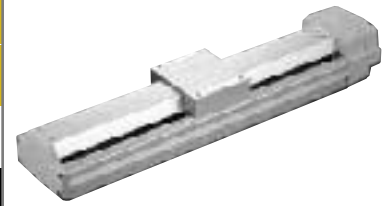

* Refer to page 11 for the details of model specification items.

Models/Specifications

Model	Encoder type	Motor output (W)	Lead (mm)	Stroke (mm) In increments of 50mm (Note 1)	Speed (mm/s)	Acceleration (Note 2)				Load capacity (Note 2)				Rated thrust (N)
						Horizontal (G)		Vertical (G)		Horizontal (kg)		Vertical (kg)		
						Rated	Maximum	Rated	Maximum	Rated acceleration	Maximum acceleration	Rated acceleration	Maximum acceleration	
ISA [ISPA] -SYM-A-60-16-***-T1-△-□	Absolute	60	16	100 - 600	1 ~ 800	0.3	1.0	0.3	0.7	12	3.5	3	2	63.7
ISA [ISPA] -SYM-A-60-8-***-T1-△-□			8		1 ~ 400	0.3	0.6	0.3	0.5	25	12	6	5	127.4
ISA [ISPA] -SYM-A-60-4-***-T1-△-□			4		1 ~ 200	0.15	0.5	0.15	0.3	50	30	14	12	254.8
ISA [ISPA] -SYM-I-60-16-***-T1-△-□	Incremental	60	16	100 - 600	1 ~ 800	0.3	1.0	0.3	0.7	12	3.5	3	2	63.7
ISA [ISPA] -SYM-I-60-8-***-T1-△-□			8		1 ~ 400	0.3	0.6	0.3	0.5	25	12	6	5	127.4
ISA [ISPA] -SYM-I-60-4-***-T1-△-□			4		1 ~ 200	0.15	0.5	0.15	0.3	50	30	14	12	254.8

* In the above model names, *** indicates the stroke, △ the cable length and □ the applicable options.

*1.0G=9800mm/sec²

Options

Name	Code	Page	Name	Code	Page
AQ seal	AQ	→ P13	Master-axis designation	LM	→ P14
Brake	B	→ P13	Master-axis designation (sensor on opposite side)	LLM	→ P14
Creep sensor	C	→ P13	Reverse homing specification	NM	→ P14
Creep sensor on opposite side	CL	→ P13	Guide with ball-retaining mechanism	RT	→ P14
Home limit switch	L	→ P14	Slave-axis designation	S	→ P14
Home limit switch on opposite side	LL	→ P14			

Common Specifications

* Refer to page 10 for the details of common specification items.

Positioning repeatability (Note 3)	±0.02mm [±0.01mm]
Drive system (Note 4)	Ball screw ø12mm, rolled C10 [equivalent to rolled C5]
Backlash (Note 5)	0.05mm or less [0.02mm or less]
Guide	Integrated with base
Allowable load moment	Ma: 28.4N • m Mb: 40.2N • m Mc: 32.8N • m
Overhung load length	Ma direction: 450mm or less, Mb/Mc directions: 450mm or less
Base	Material: Aluminum with white alumite treatment
Cable length (Note 6)	N: No cable, S: 3m, M: 5m, X □ □ : Length specification

Dimensions

* Note that changing the home direction will require the actuator to be returned to |A| for adjustment.

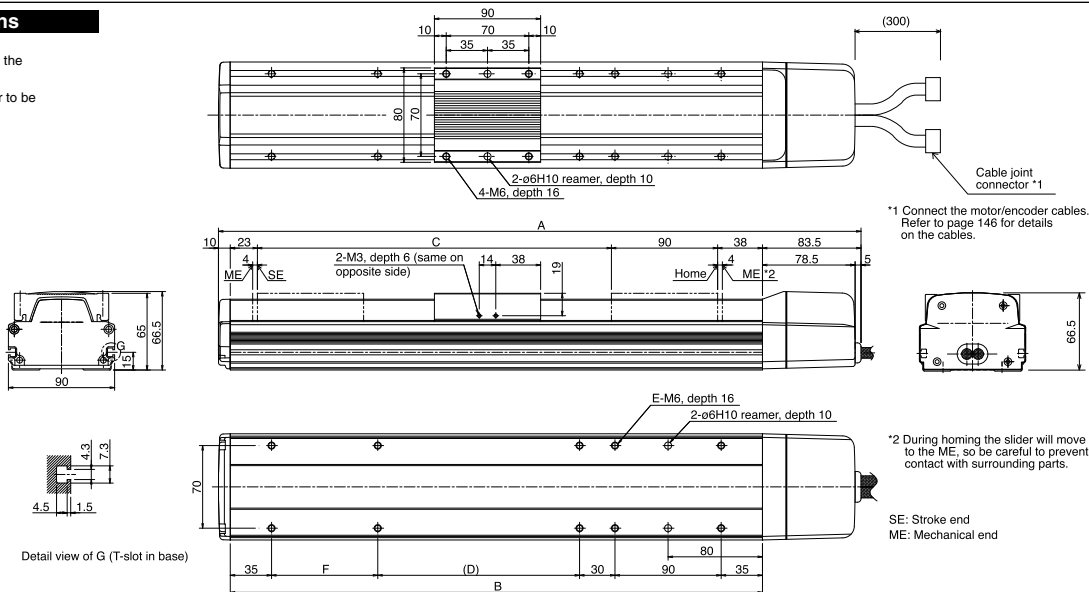

*1 Connect the motor/encoder cables. Refer to page 146 for details on the cables.

*2 During homing the slider will move to the ME, so be careful to prevent contact with surrounding parts.

Dimensions, Weight and Maximum Speed by Stroke

Stroke	100	(150)	200	(250)	300	(350)	400	(450)	500	(550)	600
A	344.5	394.5	444.5	494.5	544.5	594.5	644.5	694.5	744.5	794.5	844.5
B	251	301	351	401	451	501	551	601	651	701	751
C	100	150	200	250	300	350	400	450	500	550	600
D	61	21	71	121	171	221	271	321	371	421	471
E	8	10	10	10	10	10	10	10	10	10	10
F	-	90	90	90	90	90	90	90	90	90	90
Weight (kg)	2.8	3.2	3.5	3.9	4.2	4.6	4.9	5.3	5.6	6.0	6.3
Maximum speed (mm/s)	Lead 16	800									
	Lead 8	400									
	Lead 4	200									

Applicable Controller Specifications

Applicable controller	Maximum number of controlled axes	Compatible encoder type	Program operation	Positioner operation	Pulse-train control	Supply voltage	Page
X-SEL	4 axes	Absolute/incremental	○	△	×	AC100/200V	→ P241
E-Con	1 axis	Absolute/incremental	×	○	×	AC100/200V	→ P227
P-Driver	1 axis	Incremental	×	×	○	AC100/200V	→ P234



(Note 1) The strokes that are set in increments of 50 mm are semi-standard settings.
(Note 2) Refer to page 40 for the relationship of acceleration and load capacity.
(Notes 3, 4, 5) The figures in brackets apply to the ISPA Series.
Other specification values apply to both the ISA and ISPA Series.
(Note 6) The maximum cable length is 30 m. Specify the desired length in meters (e.g., X08 = 8 m).

* Refer to page 9 for other points to note.